



SAHARA225

The Sahara 225 features three separate living areas, a large Chic U-shaped kitchen with large breakfast bar, walk in pantry with great storage, four generously sized bedrooms, and an additional linen cupboard in the laundry for added convenience. Compact in size, yet suitable for a 12.5m x 28m allotment, our Sahara 225 makes a perfect home for the growing family or downsizer, as it gives everybody the space they deserve.

Suitable for Lot 12.5m x 28m



Total	210.17m ²	22.62sq
Ground Floor	170.07m ²	18.31sq
Garage	36.46m ²	3.92sq
Porch	3.64m ²	0.39sq

Overall Width	11.10m
Overall Length	20.94m
Suitable for Lot	12.5m x 28m

Master bed	3.65m x 3.64m
Bed 2	3.00m x 3.05m
Bed 3	3.00m x 3.00m
Bed 4	3.00m x 3.05m
Family	4.50m x 4.20m
Meals	3.38m x 3.33m
Living	3.65m x 3.47m
Lounge	3.60m x 3.14m

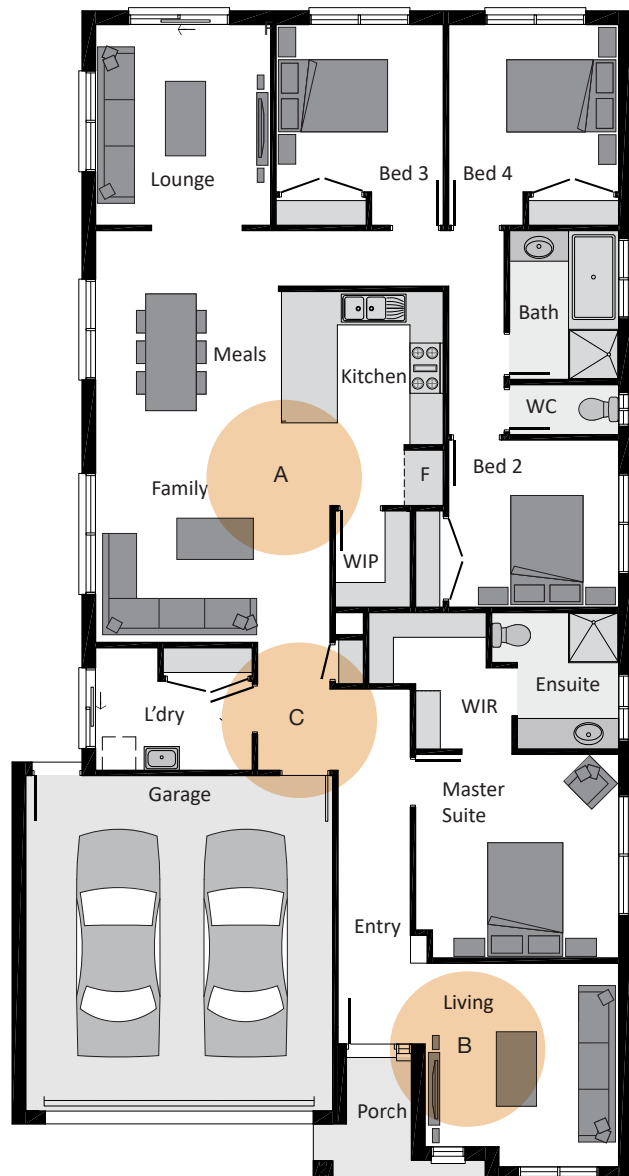

On display at Grandview Estate, Truganina

- A** Chic U-shaped kitchen with breakfast bar and large WIP
- B** Three living areas giving each family member the space they deserve
- C** Large laundry with built in linen for added convenience